

MedPick

Next-generation central pharmacy automation



Introducing MedPick

MedPick brings together Gollmann's cutting-edge robotic dispensing technology with Omnicell's proven expertise in medication workflow optimisation to deliver the most advanced automation solution for the modern NHS Central Pharmacy.

State-of-the-art robotic technology

The most space-efficient and customisable dispensing robot on the market, with its patented Dynamic Shelving concept and multiple loading and dispensing options.

Web-based workflow software

Integrate with hospital systems, orchestrate medication workflow and visualise inventory with our HubXpert platform.

Comprehensive solution design

From initial 3D concepts and configurations, to space and workflow planning, we can ensure your go-live is a success.



The most advanced pack dispensing robot available

Designed and manufactured in Germany by our partner Gollmann, we are bringing the most innovative, flexible and robust automated dispensing system to NHS Central Pharmacy.



With Gollmann's engineering expertise, this next-gen pack dispensing robot raises the bar for performance and efficiency in pharmacy care.

Feature highlights

Store and dispense medications with the Gollmann:

- **Maximises storage:** with the unique Dynamic Shelving concept, saving up to 30% of space compared to equivalent robots
- **Customisable to your space:** configure the length, width and height to design the perfect robot for your central pharmacy footprint
- **Highest-quality engineering:** to deliver optimal uptime and redundancy for exceptional availability
- **Flexibility for the future:** with plenty of options and add-ons to adjust the speed of the Gollmann robot to your pharmacy needs



Highly flexible configuration

Configure performance to your needs

Thanks to a broad range of optional modules, the performance of the Gollmann can be customised to the changing needs of your Hospital Pharmacy.

SAM picking module

SAM is an accelerator module to reduce the distance between the gripper and the dispensing chute.

Automated loader

Identify and load up to 3,000 packs per day with Optical Character Recognition technology and flexible placement options around the robot. Two loaders can be added.

Limitless layout possibilities

Including counter drops, spiral chutes, slides, ward box conveyors, and buffer conveyors for automated loading.

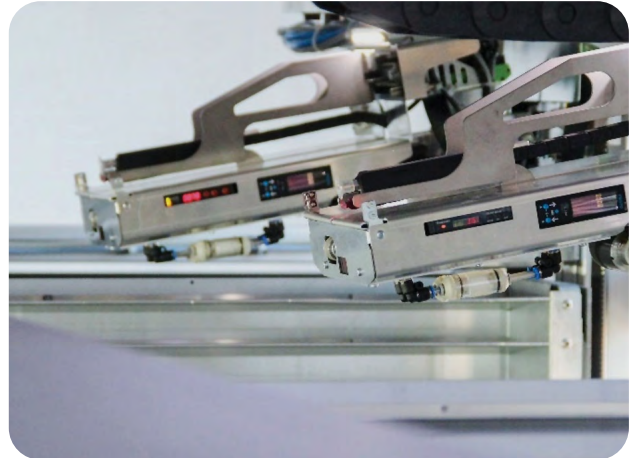

RAPID module

Three features in one for fast-movers: the module works as a pack loader, fast mover multipicking system, and prescription collector area.

Optional second arm

Increase the throughput by adding a second robot arm, allowing for parallel handling within the same robot.

Our team of Solution Designers will support you in finding the best configuration and workflow: adjust technology to your needs, not the opposite.

Smart by design

The Gollmann robot **maximises storage capacity**, with customisable dimensions to perfectly fit the unique needs of your pharmacy—optimising length, width, and height for the ideal solution. With the smallest footprint on the market, reducing footprint by up to 30%, the robot is also the **lighter solution** for your hospital pharmacy.

Configuration example

TRADITIONAL ROBOT CONCEPT

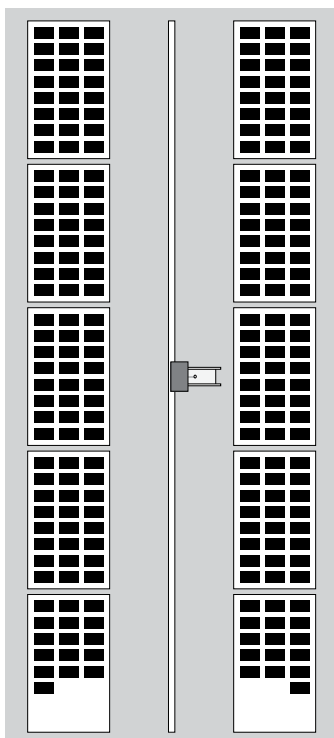

THE GOLLMANN CONCEPT

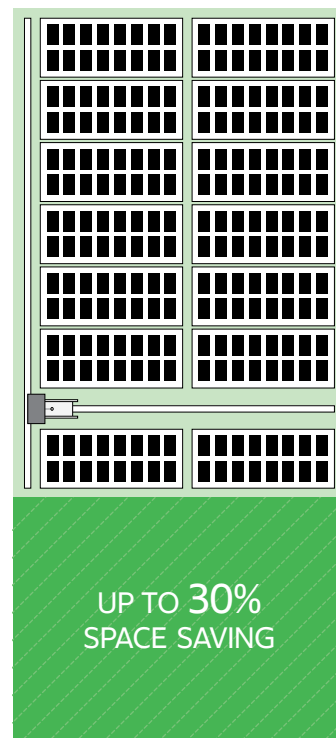

Based on your needs and requirements, our experts will help you define the ideal configuration from a wide range of dimensions:



Height: 220-355cm | Width: 128-340cm | Length: 179-626cm

HubXpert



Your Central Pharmacy orchestrator

HubXpert, our unique inventory management software, is included in every Gollmann robot installation, to ensure interoperability with other hospital systems, orchestrate medication workflows and monitor medication stocks. Operate your robot from anywhere at any time with HubXpert, with no standing at the robot required.



Loading management

-  Control **what can be stored** and **where** and track any loading movement
-  Facilitates the **loading procedure** and ensures relevant inventory level

Order management

-  **Smart Dispensing Algorithm** splitting the order content between different storage locations and using customisable criteria
-  Optimises the **dispensing activity** by guiding the user during all steps and adapts to every workflow

Inventory management

-  **Monitor the stock level** of each item, define critical levels and inform the PMS/WMS accordingly
-  Avoid shortages and waste of medications

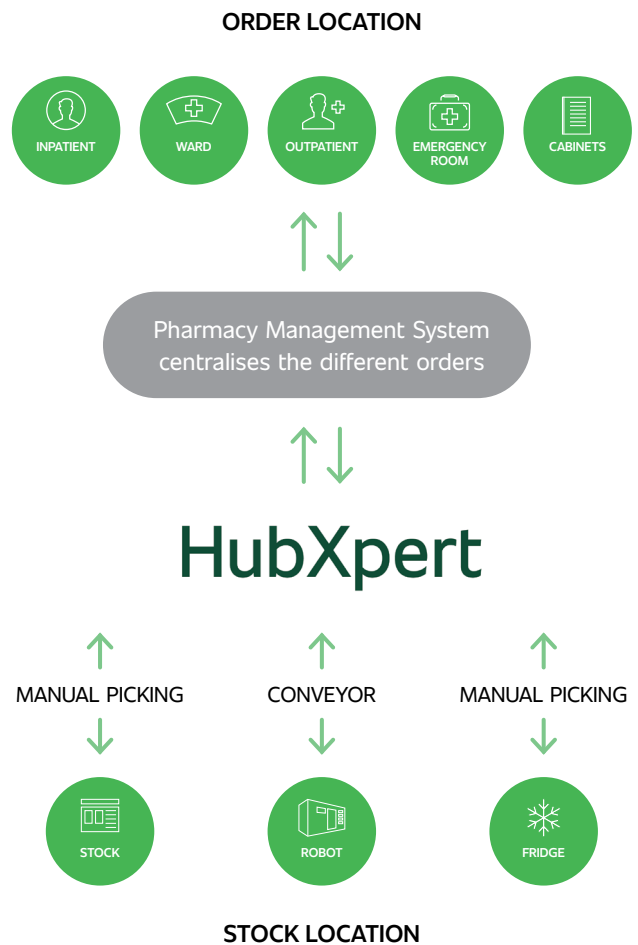

Optimise inventory, streamline orders, and ensure smooth pharmacy operations

Other key features



Drug formulary: The drug formulary feature provides a consolidated view of the drugs available in the pharmacy, enabling manual edits and full management of all item-related information.



Security: Secure access to any operation via user profiles and accounts.



Reporting: Export any data and visualise KPIs on stock management and Pharmacy activities, with automated reports.



Label printing: Print customisable labels for part packs, full packs and ward boxes.

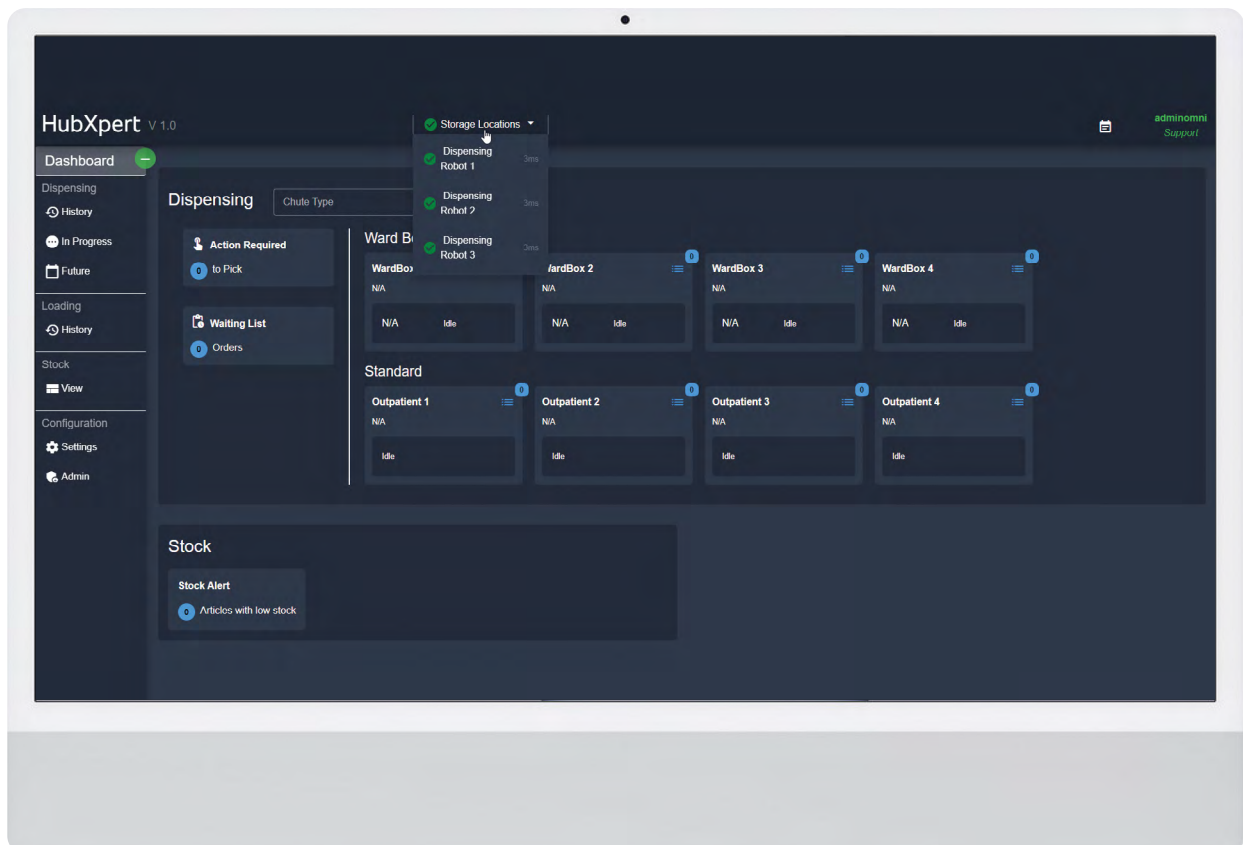



Designing a smooth path to pharmacy automation

Embracing automation with the Gollmann robot is a **game-changing step** toward greater efficiency in your pharmacy.

But we know that digital transformation can feel like a big step. That's why Omnicell's **Solutions Design Team** are here to make the process smooth and disruption-free.

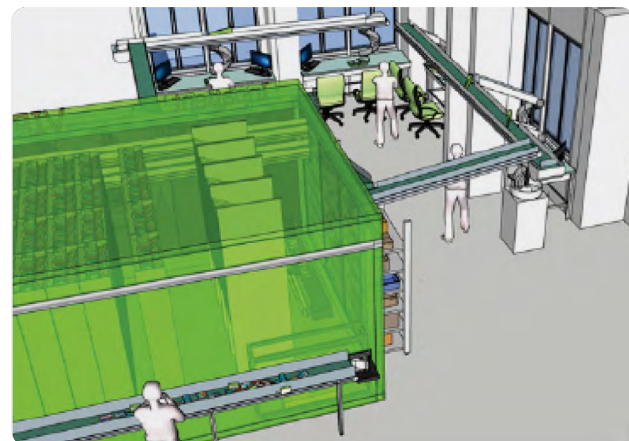
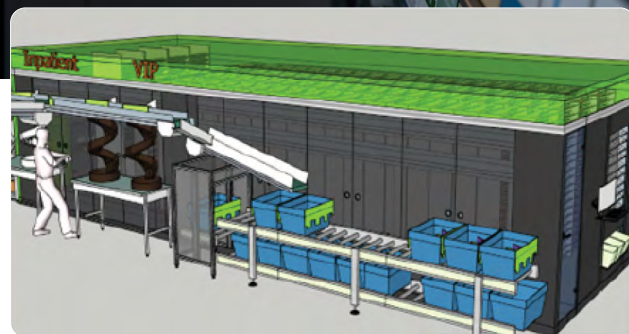

Our automation and robotics specialists will collaborate with your pharmacy to ensure a **fast, safe, and seamless implementation**.

From configuration and design concepts to workflow planning and team training, we'll help you quickly unlock the full potential of central pharmacy automation.



Want to find out more?
Don't hesitate to contact our team of experts:

automationsalesuk@omnicell.com
www.omnicell.co.uk

Omnicell and the Omnicell design mark are registered trademarks and XT is a trademark of Omnicell, Inc. in the United States and internationally. All other trademarks and trade names are the property of their respective owners. ©2025 All rights reserved.